

**CITY COUNCIL  
COMMITTEE ON ZONING, LANDMARKS AND BUILDING STANDARDS**

**COUNCIL ORDER**

**RE: Approval of sign over 100 square feet in area or over 24 feet above grade**

**ORDERED, that the City Council hereby approves the following sign application submitted by:**

**Applicant\*:** \_\_\_\_\_

(\* The Applicant is the owner of the real property or the business tenant of the real property. Do not list the sign contractor, sign erector, sign company or advertising entity in the above space.)

**This Order approves the following sign in accordance with Municipal Code of Chicago Section 13-20-680:**

**Address of Sign:** \_\_\_\_\_ **Chicago, IL 606**\_\_

**Zoning District:** \_\_\_\_\_

**DOB Sign Permit Application #:** \_\_\_\_\_

**Sign Details:**

1. On-premise \_\_\_\_\_ OR Off-premise \_\_\_\_\_
2. Static sign \_\_\_\_\_ OR Dynamic-image display sign \_\_\_\_\_
3. Number of sign faces \_\_\_\_\_
4. Projecting over the public way \_\_\_\_\_ (Yes or No) If yes, Public Way Use #: \_\_\_\_\_
5. Dimensions: Length \_\_\_\_\_ feet \_\_\_\_\_ inches Height \_\_\_\_\_ feet \_\_\_\_\_ inches  
Total square feet in area: \_\_\_\_\_ feet \_\_\_\_\_ inches
6. Height above grade: \_\_\_\_\_ feet \_\_\_\_\_ inches
7. Elevation (side of building or lot where the sign will be erected): \_\_\_\_\_
8. Name of Sign Contractor/Erector: \_\_\_\_\_

**To be legal, such sign shall comply with all provisions of Title 17 of the Chicago Municipal Code (“Zoning Ordinance”) and all other provisions of the Municipal Code governing the permitting, construction and maintenance and removal of signs and sign structures. Failure of the applicant and the applicant’s successors to comply shall be grounds for invalidation or revocation of the sign permit.**

\_\_\_\_\_  
**Alderman**

\_\_\_\_\_  
**Ward**



Proposed



Existing

## Non-Illum. Reverse Channel Letter & Sign Panel

**A**

Scale: 3/32" = 1'-0"

**Quantity**

1

**Square Footage**

69.4

**Square Footage Calculation**

Code: 5 sf per lf of street frontage of 1,800 sf whichever is less; sign on wall NTE 33% of wall area

Calculation: 5\*194=970

**Allowed: 970 sf**

**Description**

Provide 3" Deep reverse channel letters per layout; installed flush to wall w/ studs per detail

**Color Key**

- White
- PMS 281 C
- PMS 187 C
- Avery SC 900-680-0
- Avery SC 900-101-0



**EGAN SIGN**

222 NORTH KENHORST BOULEVARD, READING, PA 19607  
 PHONE: 844.460.6631 | FAX: 610.478.1332 | WWW.EGANSIGN.COM

This design/engineering proposal will remain the exclusive property of Egan Sign until approved & accepted through purchase by client named directly on drawing and may not be duplicated by other parties or design fee will apply @ \$95 per hour.



**CLIENT**  
 ABC Supply Co.  
 4219 Bethlehem Pike  
 Telford, PA 18969

**LOCATION ADDRESS**  
 ABC Supply Co  
 1760 N Kingsbury St  
 Chicago, IL 60614

**LAYOUT DATES**  
 02/22/2024 - SK  
 03/15/2024 - AR

**PROJECT NO.**  
 31753



Stud Mounted Flat Cut Out Letter  
 Face Material: (0.125) Aluminum  
 Paint Color: MP 86454 "Custom ABC Blue"  
 Face Decoration: Avery SC 900-101-O "White"  
 Performance Vinyl Applied to First Surface

White alum. panel w/ applied Avery SC 900-680-O  
 "Sapphire Blue" vinyl on face surface; installed flush to facade  
 w/ countersunk screws w/ heads white

3" Deep reverse channel letters per layout;  
 installed flush to wall w/ studs per detail

Nutsert welded to the back of  
 the face w/ all thread stud  
 Red, white & blue stripe  
 pattern from face  
 continued onto returns

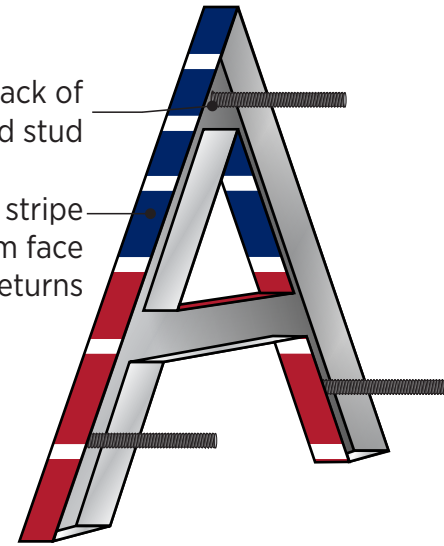

**TYPICAL BACK SIDE OF LETTER**  
 SCALE: NTS



**INSTALL DETAIL - 48" SET**  
 SCALE: 3/16"=1'-0"

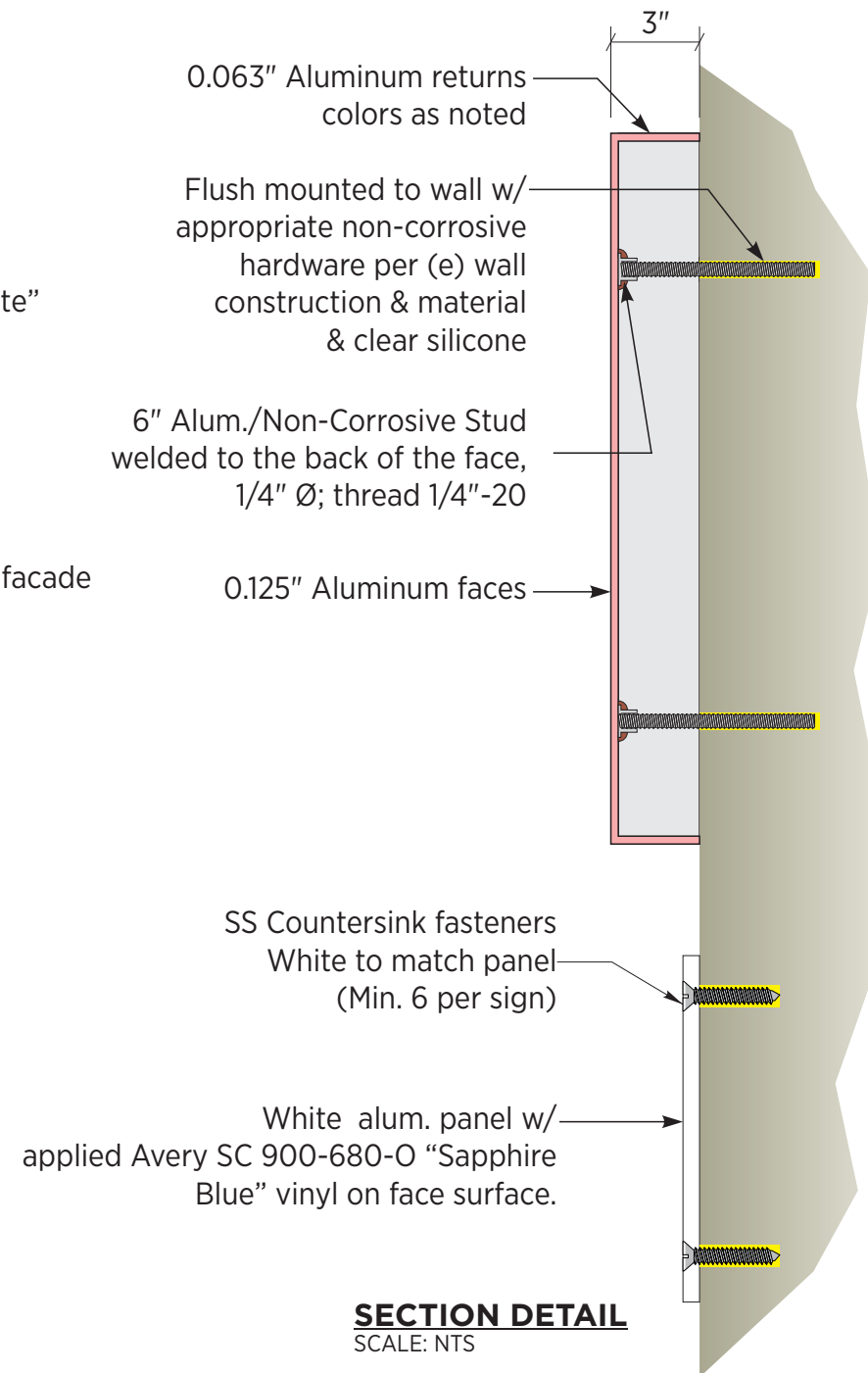

0.063" Aluminum returns  
 colors as noted  
 Flush mounted to wall w/  
 appropriate non-corrosive  
 hardware per (e) wall  
 construction & material  
 & clear silicone

6" Alum./Non-Corrosive Stud  
 welded to the back of the face,  
 1/4" Ø; thread 1/4"-20

0.125" Aluminum faces

SS Countersink fasteners  
 White to match panel  
 (Min. 6 per sign)

White alum. panel w/  
 applied Avery SC 900-680-O "Sapphire  
 Blue" vinyl on face surface.

**SECTION DETAIL**  
 SCALE: NTS

**Quantity**

1

**Square Footage**

69.4

**Square Footage Calculation**

Code: 5 sf per lf of street  
 frontage of 1,800 sf whichever  
 is less; signson wall NTE 33% of  
 wall area

Calculation: 5\*194=970

**Allowed: 970 sf**

**Description**

Provide 3" Deep reverse  
 channel letters per layout;  
 installed flush to wall w/ studs  
 per detail

**Color Key**

- White
- PMS 281 C
- PMS 187 C
- Avery SC 900-680-0
- Avery SC 900-101-0

**A Non-Illum. Reverse Channel Letter & Sign Panel**  
 Scale: 3/8" = 1'-0"

**EGAN SIGN**  
 222 NORTH KENHORST BOULEVARD, READING, PA 19607  
 PHONE: 844.460.6631 | FAX: 610.478.1332 | WWW.EGANSIGN.COM  
 This design/engineering proposal will remain the exclusive property of Egan Sign until approved & accepted through purchase  
 by client named directly on drawing and may not be duplicated by other parties or design fee will apply @ \$95 per hour.

**ABC Supply Co. inc.**  
 CLIENT  
 ABC Supply Co.  
 4219 Bethlehem Pike  
 Telford, PA 18969

**LOCATION ADDRESS**  
 ABC Supply Co  
 1760 N Kingsbury St  
 Chicago, IL 60614

**LAYOUT DATES**  
 02/22/2024 - SK  
 03/15/2024 - AR

**PROJECT NO.**  
 31753

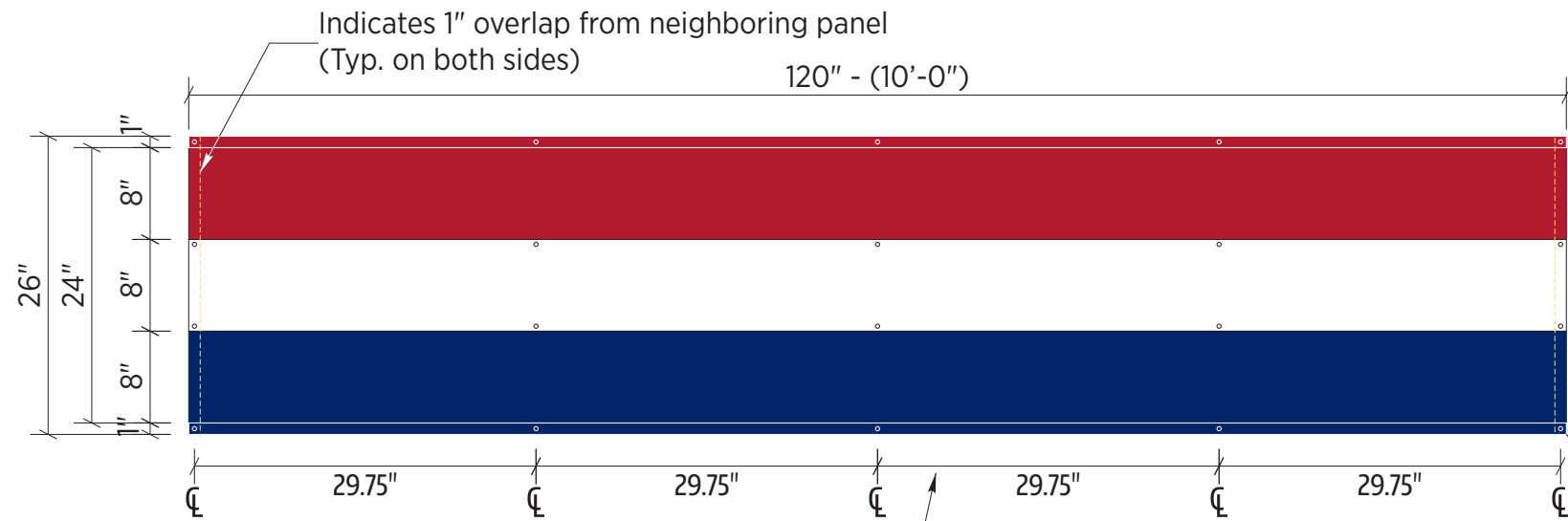

**PANEL LAYOUT DETAIL**

SCALE: NTS



**Install Pattern:**

**Red  
White  
Blue**

Non corrosive fasteners w/ caps to match corresponding panel color

Existing wall construction & EFIS (TBV)

10' prefabricated channel decorative panels attached to exterior wall w/ 1" overlap per drawing

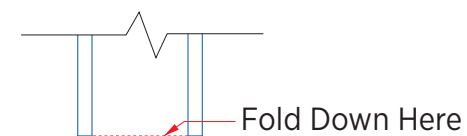

**TOP VIEW AT END (RED/BLUE)**

SCALE: NTS

**SECTION DETAIL**

SCALE: NTS

**INSTALL NOTES:**

Installer will be provided 10'-0" wide sections of the RED, WHITE & BLUE striping.

- **Installer to provide hardware.** (Touch up paint for the hardware will be provided)
- **Installer will need to trim panels** on field, refer to diagram for instructions on how to cut angles around Channel Letters.
- **Installer will need to trim and fold** the ends of the RED and BLUE panels at the sides of the building, in the field.

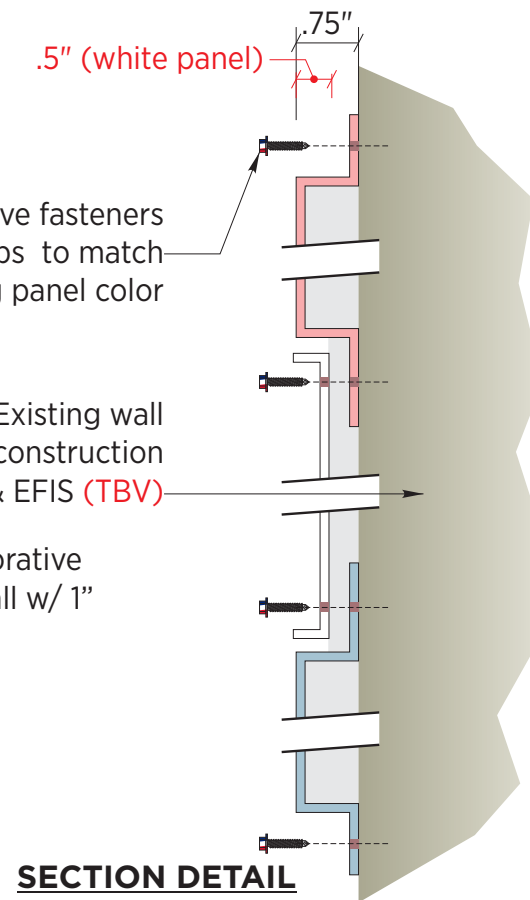

**Quantity**

7 Panels

**Square Footage**

151.9

**Square Footage Calculation**

Code: 5 sf per lf of street frontage of 1,800 sf whichever is less; signson wall NTE 33% of wall area

Calculation: 5\*194=970

**Allowed: 970 sf**

**Description**

10' prefabricated channel decorative panels attached to exterior wall w/ 1" overlap per drawing

**Color Key**

- White
- PMS 281 C
- PMS 187 C

**B** **Tri-color Decorative Wall Panels**  
Scale: 3/4" = 1'-0"



222 NORTH KENHORST BOULEVARD, READING, PA 19607  
PHONE: 844.460.6631 | FAX: 610.478.1332 | WWW.EGANSIGN.COM

This design/engineering proposal will remain the exclusive property of Egan Sign until approved & accepted through purchase by client named directly on drawing and may not be duplicated by other parties or design fee will apply @ \$95 per hour.



**CLIENT**  
ABC Supply Co.  
4219 Bethlehem Pike  
Telford, PA 18969

**LOCATION ADDRESS**  
ABC Supply Co  
1760 N Kingsbury St  
Chicago, IL 60614

**LAYOUT DATES**  
02/22/2024 - SK  
03/15/2024 - AR

**PROJECT NO.**  
31753